

- Kinder drop off students at the side “northeast” entrance by gym “K” and exit Livingston drive.
- Any car can drop off students at the front “northwest” entrance “X”.
- Any car can drop off students at the back “southeast” entrance “X” and exit Twin Buttes Drive.

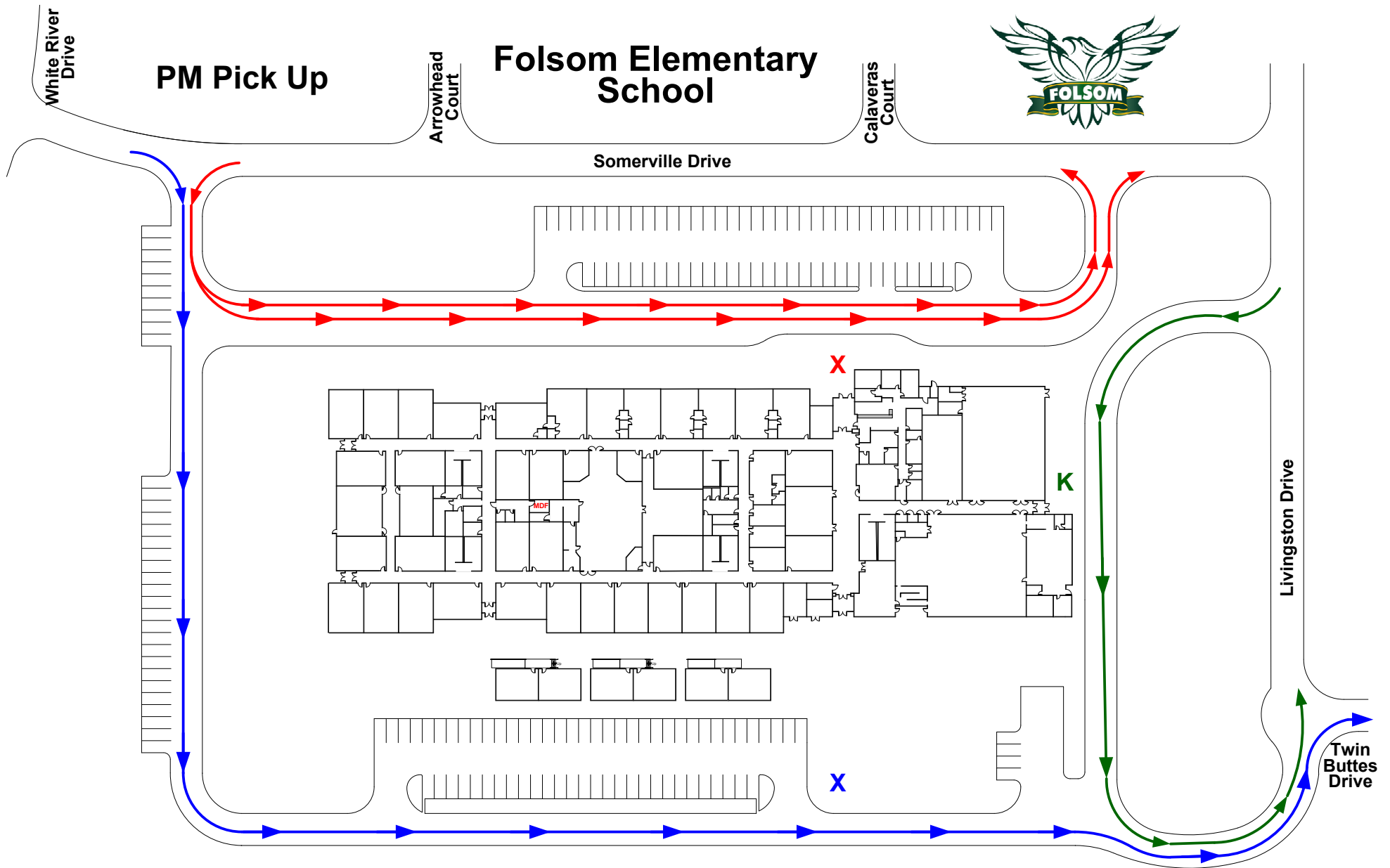

- Kinder pick up students at “northeast” entrance by gym “K” and exit Livingston drive.
- A-L last name will pick up students at front “northwest” entrance “X”.
- M-Z last name will pick up students at back “southeast” entrance “X” and exit Twin Buttes Drive.

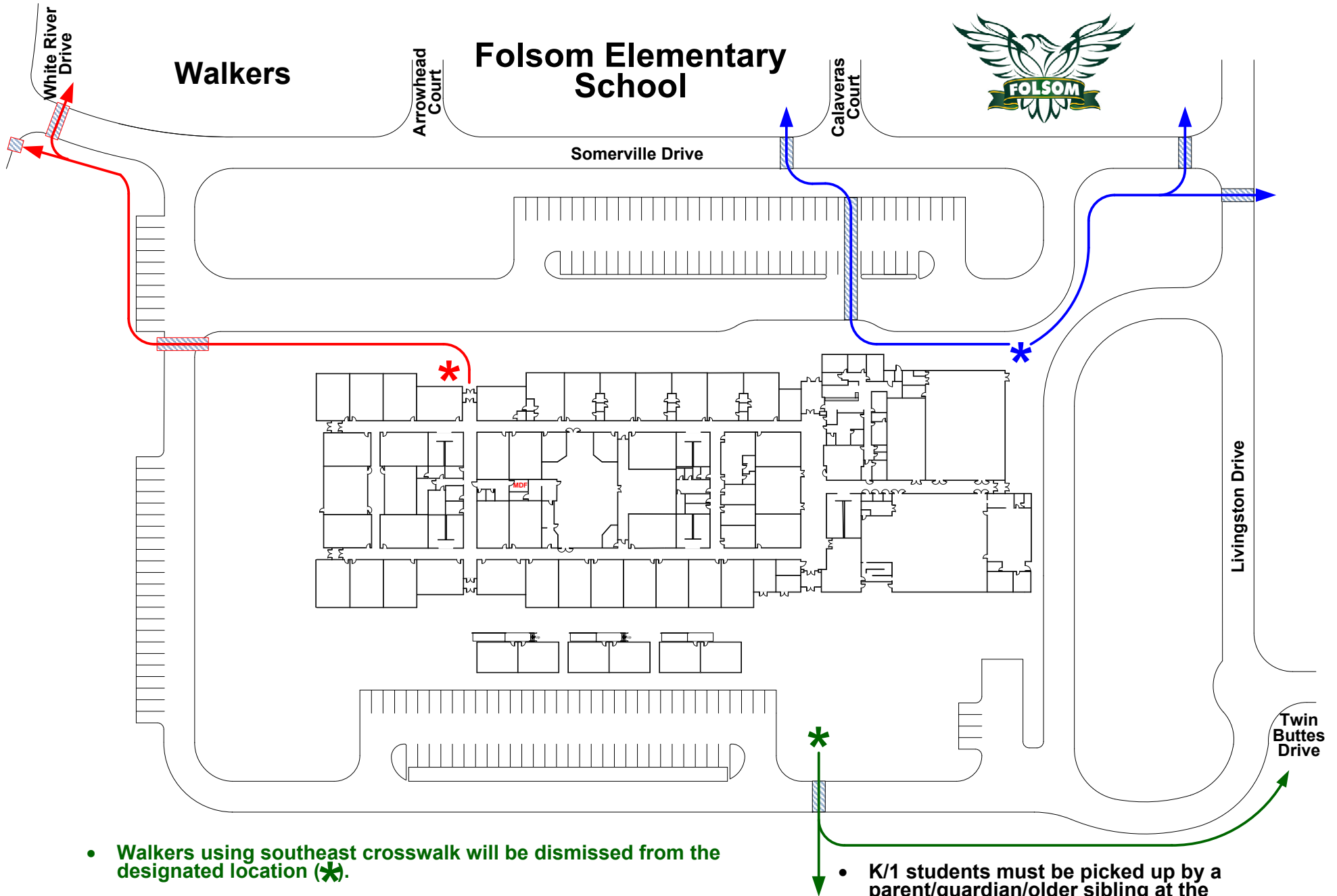

- Walkers using southeast crosswalk will be dismissed from the designated location (\*).
- Walkers using crosswalk at Somerville Dr. and Livingston will be dismissed from the designated location (\*),
- Walkers using crosswalk at White River Dr. will be dismissed from the designated location (\*),

- K/1 students must be picked up by a parent/guardian/older sibling at the designated location (\*) using their dismissal tag.
- Older sibling(s) walking home younger sibling(s) must have permission slip on file.